



COLOUR INSTRUMENTATION

Colour is an important water quality parameter for drinking water and wastewater treatment operations.



REAL-TIME COLOUR MONITORING

Detect events rapidly to take early action and improve process control.

Real Tech's real-time Colour monitoring solutions can provide significant cost savings.

Real Tech's innovative multiple wavelength sensors utilize patent-pending and proprietary technology for superior measurement performance across multiple wavelengths of light using LEDs. Many compounds absorb light in the UV-VIS spectrum including colour. Real Tech offers both bypass (CL series and MCL series) and probe (CA series and MCA series) Colour sensor options to allow the right selection for our clients needs. Multiple path length options are also available to ensure our clients have the detection range that meets their monitoring demands.

COLOUR SENSORS

CL SERIES / MCL SERIES



Real Tech's bypass Colour sensors are cabinet style instruments installed directly on a wall, railing or system backboard. Sample is supplied to the sensors from a pressurized source or from an open-channel using an accessory pump system.

The CL series Colour sensor measures colour in accordance with ISO 6271-2016:05.

LEARN MORE

The MCL series Multi-Colour sensor measures multiple colours in accordance with ISO 7887:2011 Method B.

LEARN MORE



COLOUR PROBES**CA SERIES / MCA SERIES**

Ideal for open channel / non-pressurized monitoring applications, Real Tech's robust Colour probes are submersible instruments installed directly in-situ using a pole mounting kit or chain mounting kit.

The CA Colour probe measures colour in accordance with ISO 6271-2016:05.

LEARN MORE

The MCA Multi-Colour probe measures multiple colours in accordance with ISO 7887:2011 Method B.

LEARN MORE**CONFIGURATION EXAMPLES**

(Configurations shown includes probe/sensor, controller and recommended cleaning system)

**Not shown in illustration examples*

CL SERIES / MCL SERIES

Pressurized Applications



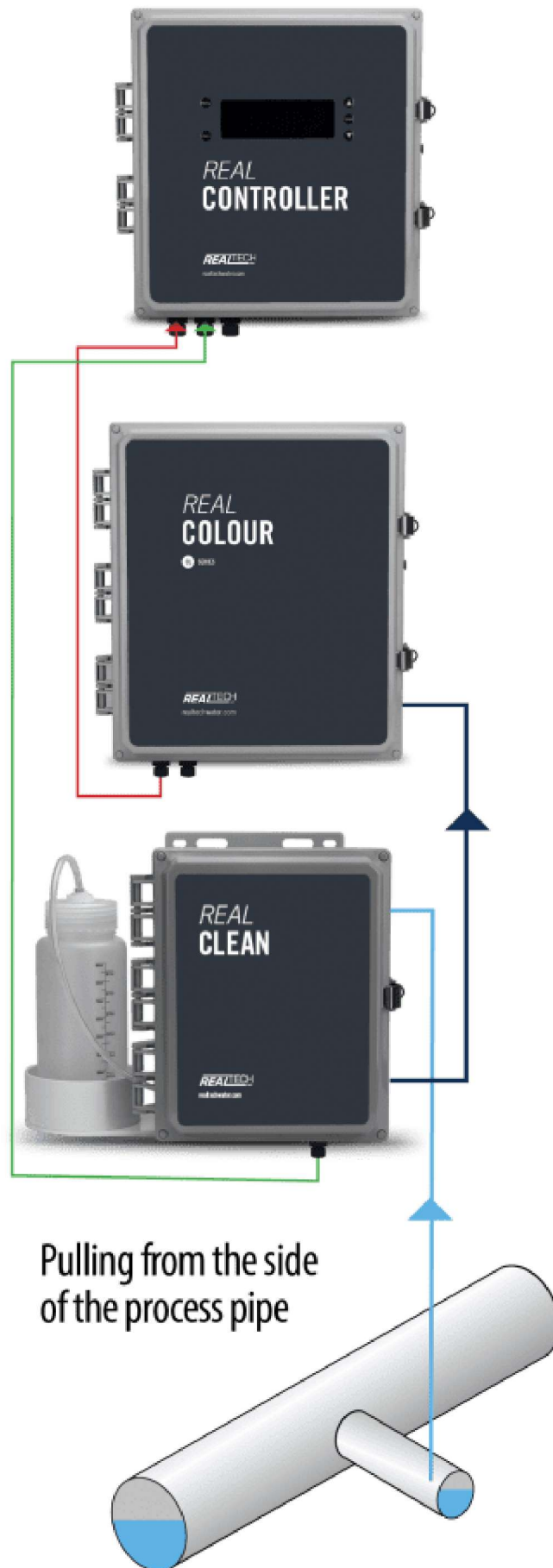

Pulling from the side of the process pipe



CONTROLLER

Real Controller
(upgrade to Pro* version available)

SENSOR FORM FACTOR

Bypass sensor

ACCESSORIES

Real Clean

ADD-ON OPTIONS*

Dual Feed

(used to monitor two sample streams or used for intermittent flow installations, note this requires clean water at monitoring location)

Liquid Ai Data Services

CA SERIES / MCA SERIES

Open Channel Applications



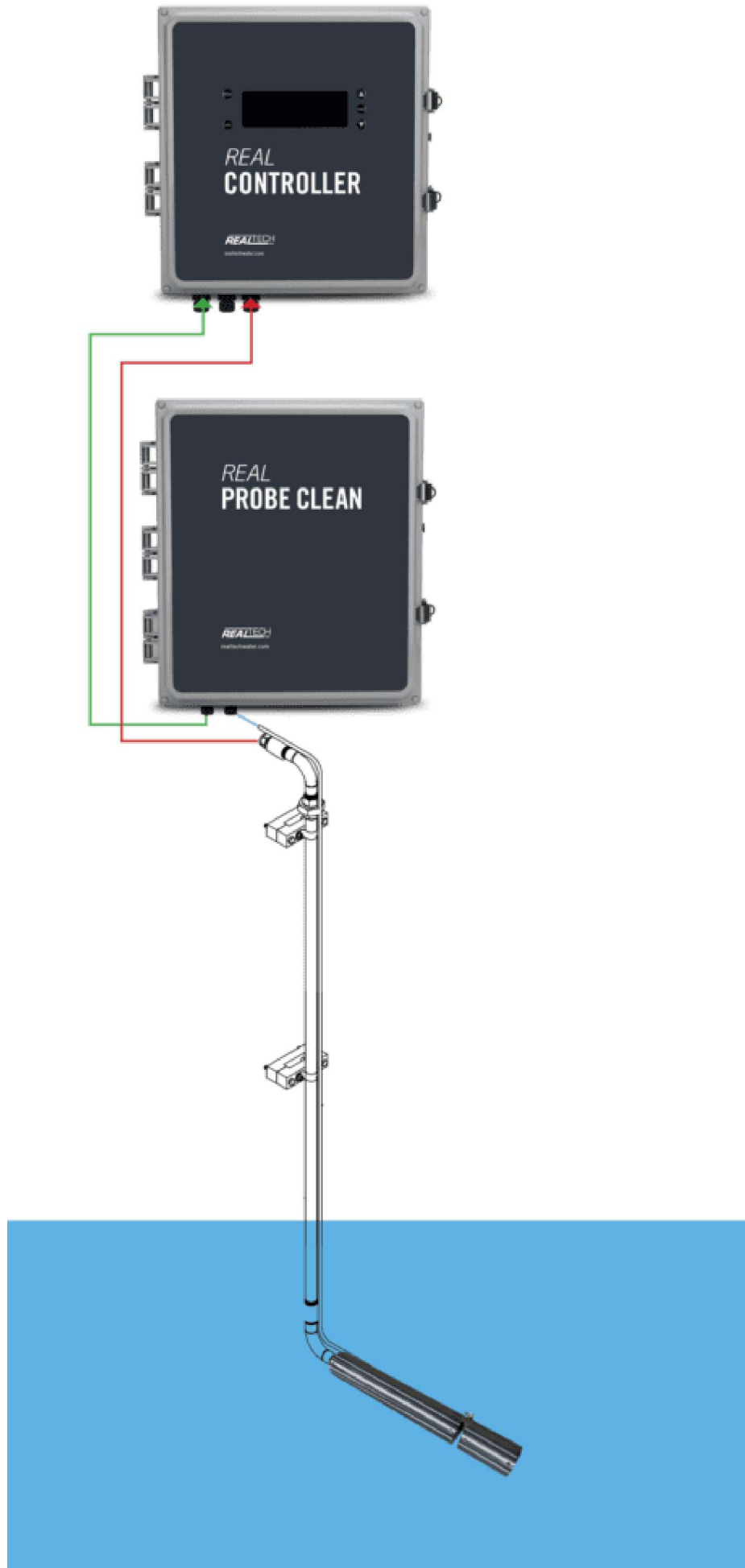

CONTROLLER

Real Controller
(upgrade to Pro* version available)

SENSOR FORM FACTOR

Probe sensor

ACCESSORIES

Probe Clean

ADD-ON OPTIONS*

Air Compressor
(when no compressor air is onsite)

Liquid Ai Data Services

